

Up to 9,214 SF

**190 WELLES STREET
SUITE 166**

CROSS VALLEY WEST PROFESSIONAL BUILDING
FORTY FORT, PA 18704



MODERN OFFICE & MEDICAL SPACE

JUST ¼ MILE FROM THE CROSS VALLEY EXPRESSWAY (SR 309)



SPECIFICATIONS

SIZE

- Up to 9,214 SF of available office/medical space in a 381,881 SF building.
- Multiple space combinations possible.
- File storage space also available.

BUILDING CONSTRUCTION

- Existing specialty equipment includes a therapy pool and shower rooms.
- Available space is accessed by an existing, private, covered entrance at grade.
- Exterior wall construction has concrete masonry with an architecturally designed, exterior insulated finishing system, and thermally-broken, aluminum frame, insulated glass, windows.
- Available space flooring is a mixture of carpeting, vinyl composition tile, porcelain floor tile, and sealed concrete.
- Available space has an existing acoustical suspended ceiling system at approximately 9'-0" above finish floor. The large open office area is at a nominal 10'-0" above finish ceiling.

LOCATION

- 1/4 mile from the Cross Valley Expressway (Route 309)

UTILITIES

- Available space has existing general lighting with 2 x 4 fluorescent troffer fixtures with prismatic lenses. The reception and waiting areas have parabolic lenses.
- 200 amp 120/208 volt 3 phase electrical service
- Available space has existing heating and cooling supplied by electric/gas roof top packaged unit.
- Existing design includes additional exhaust/ventilation for Therapy Pool Room and Shower Rooms.
- Available space has an existing, light hazard, sprinkler system
- Provisions for domestic water and natural gas shall be provided.
- Provisions for domestic water and natural gas shall be provided.
- All utilities shall be separately metered.

PARKING

- Six (6) dedicated and thirty-four (34) first-come, first serve parking spaces available.

PROXIMITY TO MAJOR MEDICAL FACILITIES

FACILITY

MILES

WILKES-BARRE GENERAL HOSPITAL	1.70
VETERANS AFFAIRS MEDICAL CENTER	3.50
JOHN HEINZ REHAB	3.50
GEISINGER SOUTH WILKES-BARRE	4.75
GEISINGER WYOMING VALLEY	5.25

DEMOGRAPHICS

POPULATION

MILES

11,193	1
75,846	3
132,672	5
223,150	10
319,659	15
448,652	20

FLOOR PLAN



CONCEPTUAL FLOOR PLANS

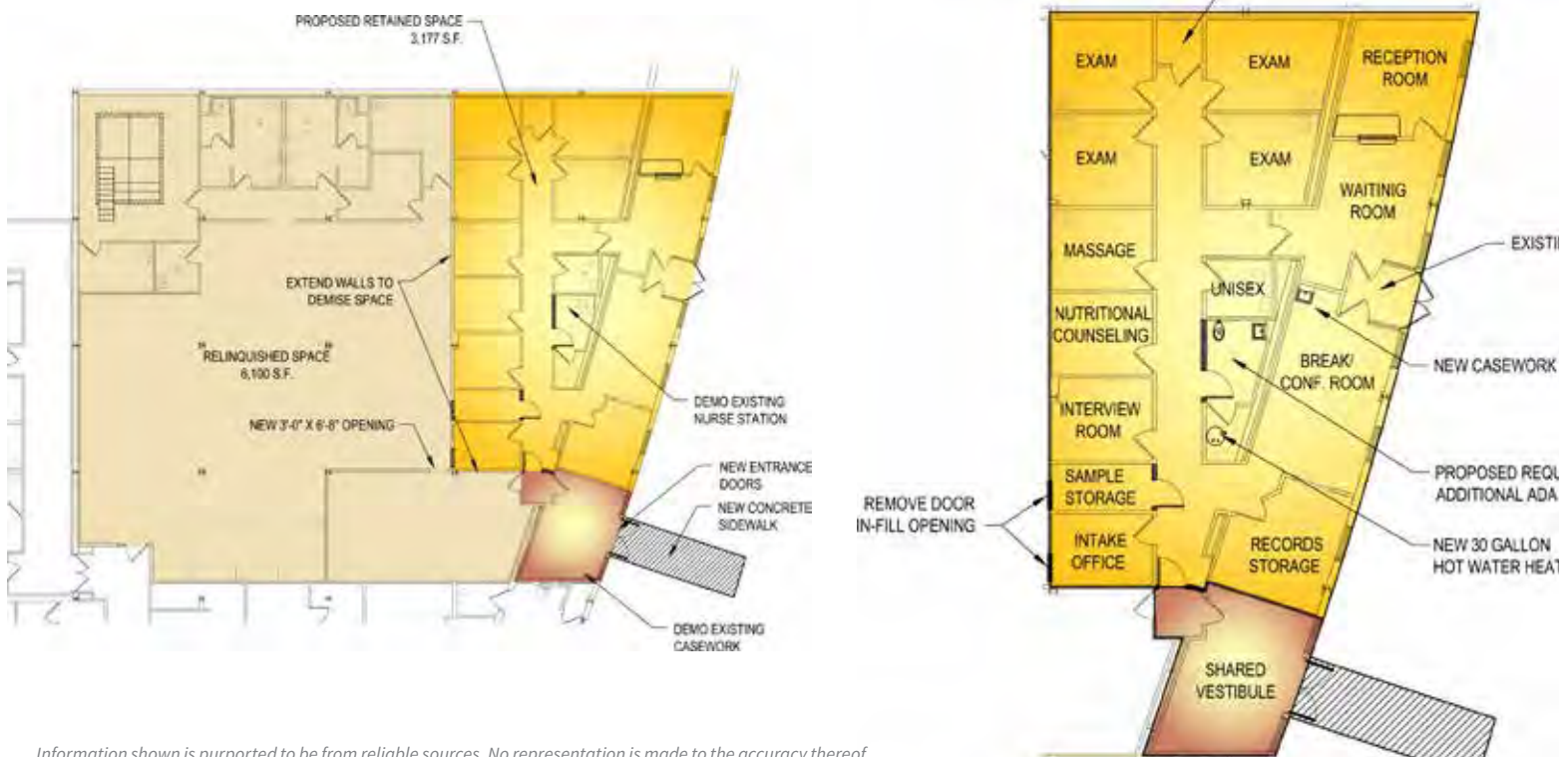

190 WELLES STREET, SUITE 166
CROSS VALLEY WEST PROFESSIONAL BUILDING
FORTY FORT, PA 18704

UP TO 9,277 SF FOR LEASE



MERICLE
COMMERCIAL REAL ESTATE SERVICES



mericle.com

SERVING PENNSYLVANIA'S 1-81 CORRIDOR • 570.823.1100
EAST MOUNTAIN CORPORATE CENTER • 100 BALTIMORE DRIVE, WILKES-BARRE, PA 18702

FLOOR PLAN

**AVAILABLE 9,214 SF MEDICAL CLINIC FACILITY
WITHIN AN EXISTING 381,881 SF BUILDING**

**SUITE 166
190 WELLES STREET
CROSS VALLEY WEST
PROFESSIONAL BUILDING
FORTY-FORT, PA 18704**

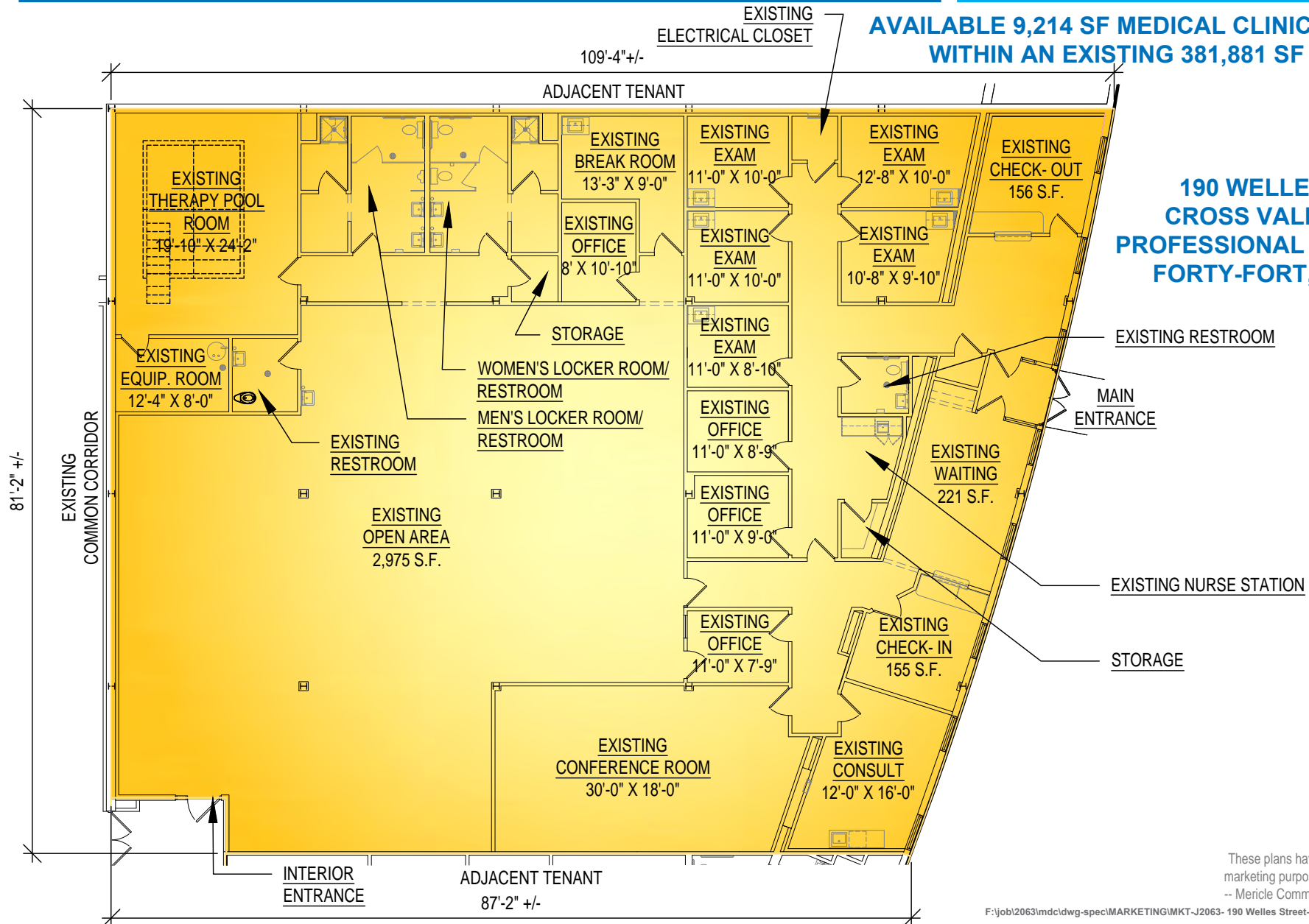

These plans have been prepared solely for marketing purposes for the exclusive use of -- Mericle Commercial Real Estate Services

F:\job\2063\mdcdwg-spec\MARKETING\MKT-J2063- 190 Welles Street- Suite 166- 09152017.dwg ck

570.823.1100
mericle.com



East Mountain Corporate Center
100 Baltimore Drive
Wilkes-Barre, PA 18702





Developing Northeastern Pennsylvania's I-81 Corridor Since 1985

SITE PLAN

**AVAILABLE 9,214 SF MEDICAL CLINIC FACILITY
WITHIN AN EXISTING 381,881 SF BUILDING**

**SUITE 166
190 WELLES STREET
CROSS VALLEY WEST
PROFESSIONAL BUILDING
FORTY-FORT, PA 18704**

ENTRANCE

 AVAILABLE SPACE
 LEASED
 COMMON SPACE
 UTILITY SPACE

These plans have been prepared solely for marketing purposes for the exclusive use of -- Mericle Commercial Real Estate Services

F:\job\2063\mdc\dwg-spec\MARKETING\MKT-J2063- 190 Welles Street- Suite 1666- 09152017.dwg ck

570.823.1100
mericle.com



East Mountain Corporate Center
100 Baltimore Drive
Wilkes-Barre, PA 18702

Developing Northeastern Pennsylvania's I-81 Corridor Since 1985

SPECIFICATIONS

AVAILABLE 9,214 SF MEDICAL CLINIC FACILITY WITHIN AN EXISTING 381,881 SF BUILDING

SITE IMPROVEMENTS

- Six (6) dedicated, and thirty-four (34) first-come, first serve parking spaces available.
- Asphalt paved parking lot with professionally maintained landscaping.
- Sign locations available at street entrance monument sign, building exterior and building interior.
- Shared exterior patio area available.

SUITE 166
190 WELLES STREET
CROSS VALLEY WEST
PROFESSIONAL BUILDING
FORTY-FORT, PA 18704

BUILDING IMPROVEMENTS

- Available space is 9,214 S.F.
- Building contains 381,881 S.F.
- Available space is accessed by an existing entrance at grade.
- Exterior wall construction has concrete masonry with an architecturally designed, exterior insulated finishing system, and thermally-broken, aluminum frame, insulated glass, windows.
- Available space has an existing acoustical suspended ceiling system at approximately 9'-0" above finish floor. The large open office area is at a nominal 10'-0" above finish ceiling.
- Existing specialty equipment includes a therapy pool/pool equipment and shower rooms, and existing sink bases at Exam Rooms.
- Available space flooring is a mixture of carpeting, vinyl composition tile, porcelain floor tile, and sealed concrete.
- Available space has existing general lighting with 2 x 4 fluorescent troffer fixtures with prismatic lenses.
- The Reception and Waiting areas have parabolic lenses.
- Available space has a 200 amp 120/208 volt 3 phase, electrical service.
- Available space has existing heating and cooling supplied by electric/gas roof top packaged unit.
- Existing design includes additional exhaust/ventilation for Therapy Pool Room and Shower Rooms.
- Available space has an existing, Light Hazard, sprinkler system.
- Provisions for domestic water and natural gas shall be provided.
- All utilities shall be separately metered.

These plans have been prepared solely for
marketing purposes for the exclusive use of
-- Mericle Commercial Real Estate Services

F:\job\2063\mdc\dwg-spec\MARKETING\MKT-J2063- 190 Welles Street- Suite 1666- 09152017.dwg ck

570.823.1100
mericle.com



East Mountain Corporate Center
100 Baltimore Drive
Wilkes-Barre, PA 18702

Developing Northeastern Pennsylvania's I-81 Corridor Since 1985