

21,085 SF

ON 11.56 ACRES

195 RESEARCH DRIVE
CENTERPOINT COMMERCE & TRADE PARK EAST
JENKINS TOWNSHIP, PA



LERTA APPROVED

MULTI-YEAR, 100% REAL ESTATE TAX ABATEMENT ON IMPROVEMENTS!

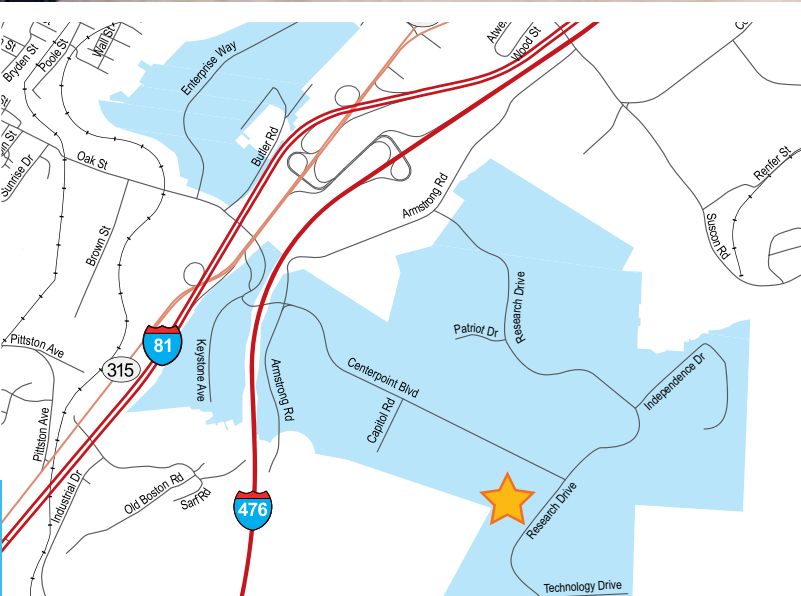

DIRECTIONS TO CENTERPOINT EAST:

Traveling North on I-81 - Take Exit 175 (Pittston/Route 315 North). Once off exit ramp, make first right just before the light at the car dealership. Follow road under I-476 overpass. Proceed straight into park.

Traveling South on I-81 - Take Exit 175A (Pittston/Route 315 South). Follow Rt. 315 south 1/2 mile to first light. Turn left and follow road under I-476 overpass. Proceed straight into park.

Traveling on I-476 (PA Turnpike) - Take Exit 115 (Wyoming Valley). Follow Rt. 315 south 1/2 mile to first light. Turn left and follow road under I-476 overpass. Proceed straight into park.

PLANS AND SPECIFICATIONS

SIZE

- **Available space SF:** 21,085 - divisible by 7,028 SF
- **Available space:** 120' (length) x 175' (depth)
- **Office space:** Existing 3,239 SF (expandable)
- **Acreage:** 11.56
- **Building total SF:** 98,000
- **Building size:** 560' (length) x 175' (depth)

BUILDING CONSTRUCTION

- **Floor:** 6" 4,000 PSI, welded steel mat reinforced concrete
- **Roofing:** MR24 standing seam
- **Wall Systems:** Architectural Masonry/ Exterior Insulation Finish Systems / Glazed, Aluminum Entrance Systems / Insulated Metal Wall Panels
- **Clear Ceiling Height:** 29'-11" to 33'-6"
- **Column Spacing:** 40' X 57'-6" with 60' staging bay

LOADING

- **Loading:** Rear dock
- **Dock Positions:** 3 - 5
- **Dock Equipment:** 8'6" x 9'6" manual vertical-lift doors, 30,000 lb Rite-Hite, mechanical dock levelers
- **Trailer Court/s:** 130' with 8", 60' reinforced concrete apron
- **Drive-in Doors Available:** (1) 12' x 14' with 60' concrete ramp

UTILITIES

- **HVAC: Warehouse** - Energy-efficient indirect gas-fired suspended unit heaters
- **HVAC: Office** - Energy-efficient gas heat/electric cooling packaged rooftop units
- **Electrical Service:** 225 Amp, 208/120 Volt, 3 phase (expandable to 800 Amps)
- **Lighting: Warehouse** - Energy-efficient fluorescent Tbay fixtures
- **Lighting: Office** - Energy-efficient recessed fluorescent fixtures
- **Fire Protection: Warehouse** - Ordinary Hazard Class III (ESFR capable)
- **Fire Protection: Office** - Light Hazard
- **Utilities:** Separately Metered, Public Water, Sewer, Gas and Electric
- **Telecommunications:** Fiber optic and copper facilities available

PARKING

- **Vehicular Parking:** 10 - 47
- **Trailer Parking:** 32

LOCATION

- Less than one mile from I-81 and I-476
- More than 470,000 live within 20 miles of the park
- **Additional Improvements:** Tenant Marquis Signage



SITE PLAN

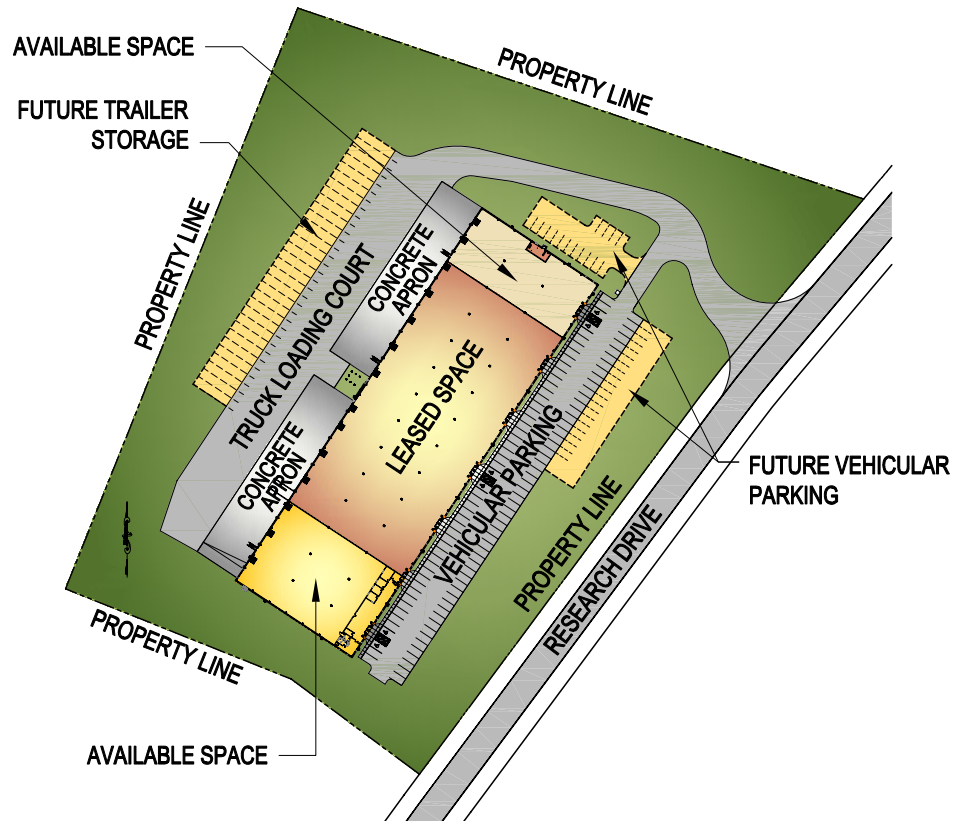

FLOOR PLAN

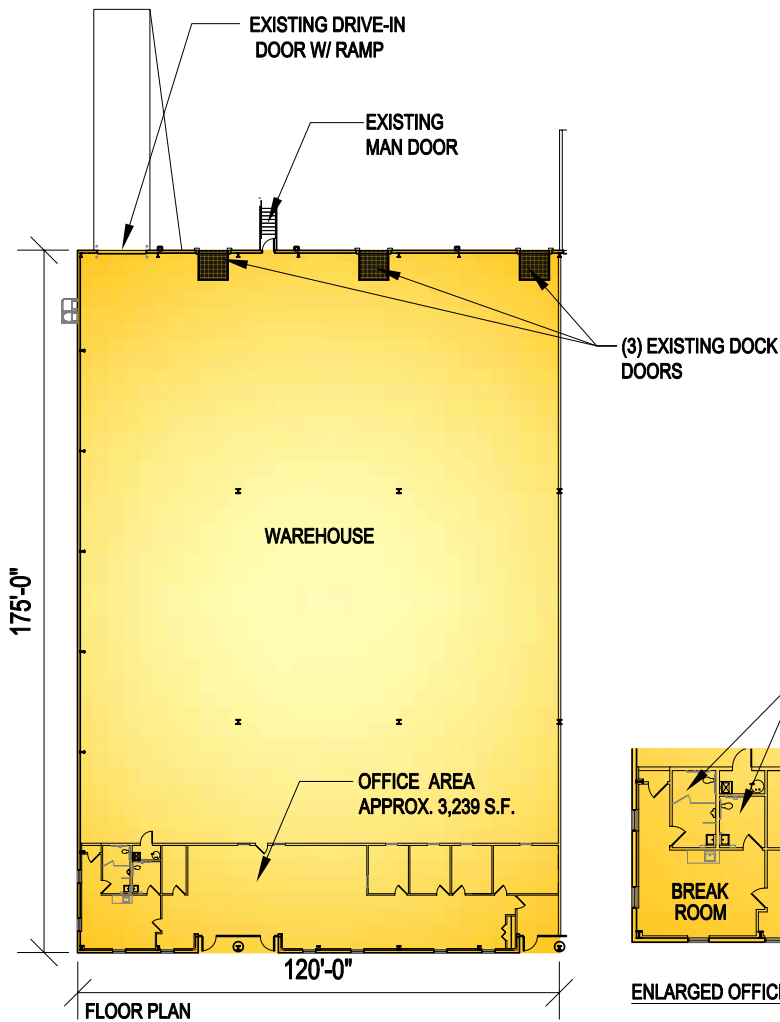

Information shown is purported to be from reliable sources. No representation is made to the accuracy thereof, and is submitted subject to errors, omissions, prior sale/lease, withdrawal notice, or other conditions.

OFFICE PLAN

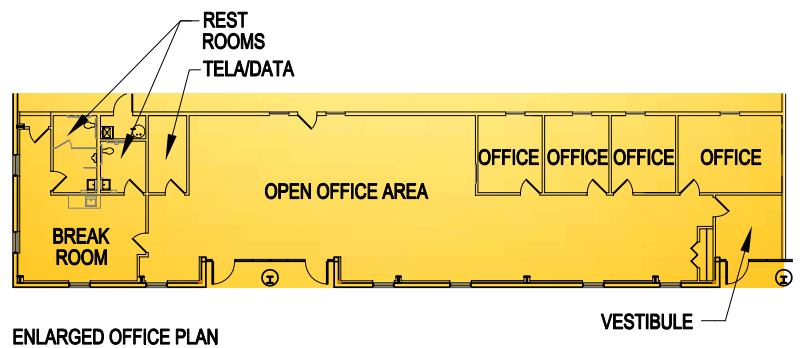

195 RESEARCH DRIVE
CENTERPOINT COMMERCE & TRADE PARK EAST
JENKINS TOWNSHIP, PA

21,085 SF FOR LEASE
ON 11.56 ACRES



MERICLE
COMMERCIAL REAL ESTATE SERVICES

EAST MOUNTAIN CORPORATE CENTER
100 BALTIMORE DRIVE
WILKES-BARRE, PA 18702

mericle.com | mericlereadytogo.com

DEVELOPMENT DIVISION
570.823.1100