

# 7,509 SF

ON 8.55 ACRES IS AVAILABLE FOR LEASE

**157-159 CENTERPOINT BLVD.**

CENTERPOINT COMMERCE & TRADE PARK EAST  
JENKINS TOWNSHIP, PA



## PLUG N' PLAY OFFICE SPACE

| [mericlereadytogo.com/145-173CenterPointBlvd](https://mericlereadytogo.com/145-173CenterPointBlvd) |

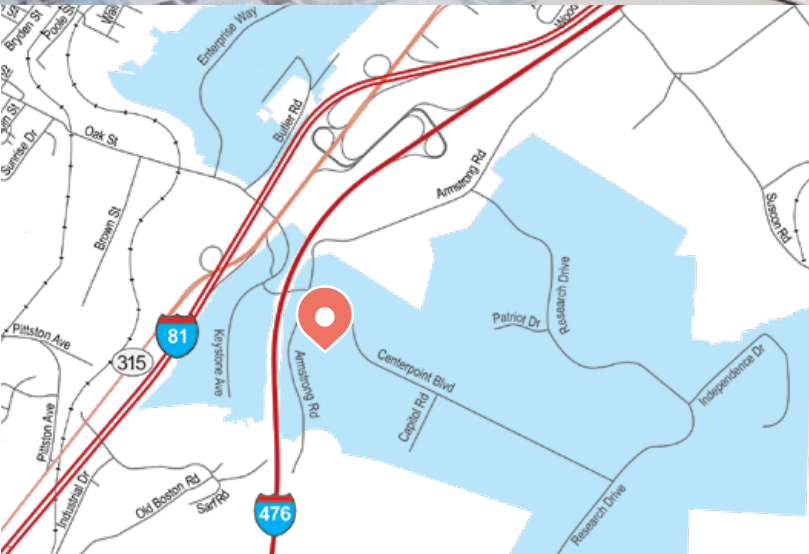

### CENTERPOINT FEATURES

- ✓ Park is less than one mile from I-81 and I-476.
- ✓ Immediate proximity to FedEx Ground, FedEx Express, FedEx Smart Post, and UPS.
- ✓ More than 700,000 people live within 30 miles.
- ✓ Two hours from New York City and Philadelphia.
- ✓ More than 51 million people live within 200 miles.
- ✓ Public water, sewer, natural gas, fiber, and power.
- ✓ The park is home to office and healthcare functions for firms such as Geisinger, Benco Dental, Boden, Maximus, and C3i.



Mericle, a Butler Builder®, is proud to be part of a network of building professionals dedicated to providing you the best construction for your needs.

[mericle.com](https://mericle.com) | 570.823.1100

## SITE PLAN



## FLOOR PLAN

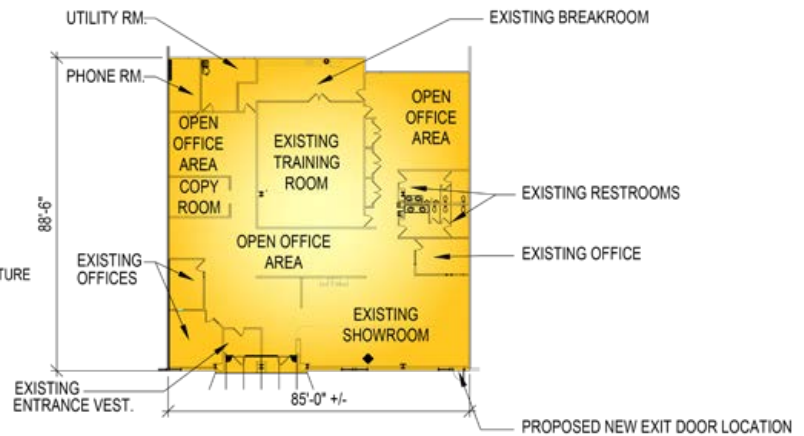

## SIZE

- **Available Space:** Fully furnished 7,509 SF of office space, divisible to 3,753 SF.
- **Acreage:** 8.55 acres
- **Building Size:** 84,121 SF
- **Building Dimensions:** 560' (length) x 150' (depth)

## BUILDING CONSTRUCTION

- **Floor:** 6" thick concrete floor slab reinforced with welded steel mats.
- **Roof:** Butler Manufacturing, MR-24 metal roof system.
- **Exterior Walls:** Architectural masonry, aluminum/glazing entrance systems and metal wall panels with insulation.
- **Clear Ceiling Height:** 10'-0" above finish floor.
- The interior office finishes are upgraded with carpet tile, wallpaper, and ceramic wall tile in restrooms.
- Break Room comes equipped with refrigerator, microwave, and dishwasher.

## PARKING

- Asphalt paving including heavy duty pave in truck areas.
- On-site parking for approx. 23 vehicles.

## UTILITIES

- **HVAC:** Packaged roof top units.
- **Electrical Service:** 200 amp, 120/208 volt, 3-phase service.
- **Lighting:** 2 x 4 fluorescent troffers with parabolic lenses.
- **Fire Protection:** Ordinary Hazard Class III wet sprinkler system.
- **Utilities:** All utilities shall be separately metered.
- Provisions for domestic water and natural gas shall be provided.

## LOCATION

- Park is less than one mile from I-81 and I-476.
- More than 470,000 live within 20 miles of the park.
- Foreign Trade Zone status possible.
- Located in close proximity to FedEx Ground, FedEx Express, FedEx SmartPost, and UPS.
- Centrally located within Scranton/Wilkes-Barre labor market.



Northeastern Pennsylvania is the center of the Boston/Washington Corridor and is at the confluence of five major highways. Interstates 81, 80, 84, 380 and 476 meet at this inland hub and provide excellent access to firms wishing to serve Maine to Virginia and west to Ohio.



## CENTRALLY LOCATED ON NORTHEASTERN PENNSYLVANIA'S I-81 CORRIDOR

### DEEP WATER PORTS

PORT	MI	KM
Philadelphia	120	193
New York/New Jersey	121	195
Wilmington	132	212
Baltimore	191	307

### TRAVEL DISTANCES

CITY	MI	KM
Delaware Water Gap, PA	57	92
Allentown, PA	67	108
Morristown, NJ	96	155
Philadelphia, PA	113	182
Harrisburg, PA	116	187
Port Newark, NJ	126	203
New York, NY	128	206
Syracuse, NY	152	245
Baltimore, MD	194	312
Hartford, CT	198	319
Washington, DC	237	381
Pittsburgh, PA	290	467
Boston, MA	301	484



**EXCEPTIONALLY TALENTED LOCAL WORKFORCE  
AND JOB TRAINING GRANTS AVAILABLE**

## EMPLOYMENT & UNEMPLOYMENT DATA

FOR LACKAWANNA & LUZERNE COUNTIES

**MORE THAN 470,000 PEOPLE LIVE WITHIN 20 MILES OF CENTERPOINT**

YEAR	NEPA REGION CIVILIAN LABOR FORCE	EMPLOYED	UNEMPLOYED	NEPA	PA	US
2019	263,600	251,500	12,100	4.6%	3.9%	3.8%
2018	264,800	250,300	14,600	5.4%	4.8%	4.1%
2017	263,600	248,700	14,900	5.6%	4.9%	4.4%





**157-159 CENTERPOINT  
BOULEVARD**  
CENTERPOINT EAST  
JENKINS TOWNSHIP,  
PENNSYLVANIA

## DEVELOPMENT DIVISION

**BOB BESECKER, VP**  
bbesecker@mericle.com

**JIM HILSHER, VP**  
jhilsher@mericle.com

**BILL JONES, VP**  
bjones@mericle.com

To learn more, please call one of us at **570.823.1100** to request a proposal and/or arrange a tour.



## EXISTING SITE PLAN

AVAILABLE 7,509 S.F. OFFICE SPACE WITHIN  
AN EXISTING 84,121 S.F. BUILDING

PARCEL #2

157-159 CENTERPOINT BOULEVARD  
CENTERPOINT COMMERCE  
AND TRADE PARK-EAST  
JENKINS TOWNSHIP  
PITTSBURGH, PA 15204

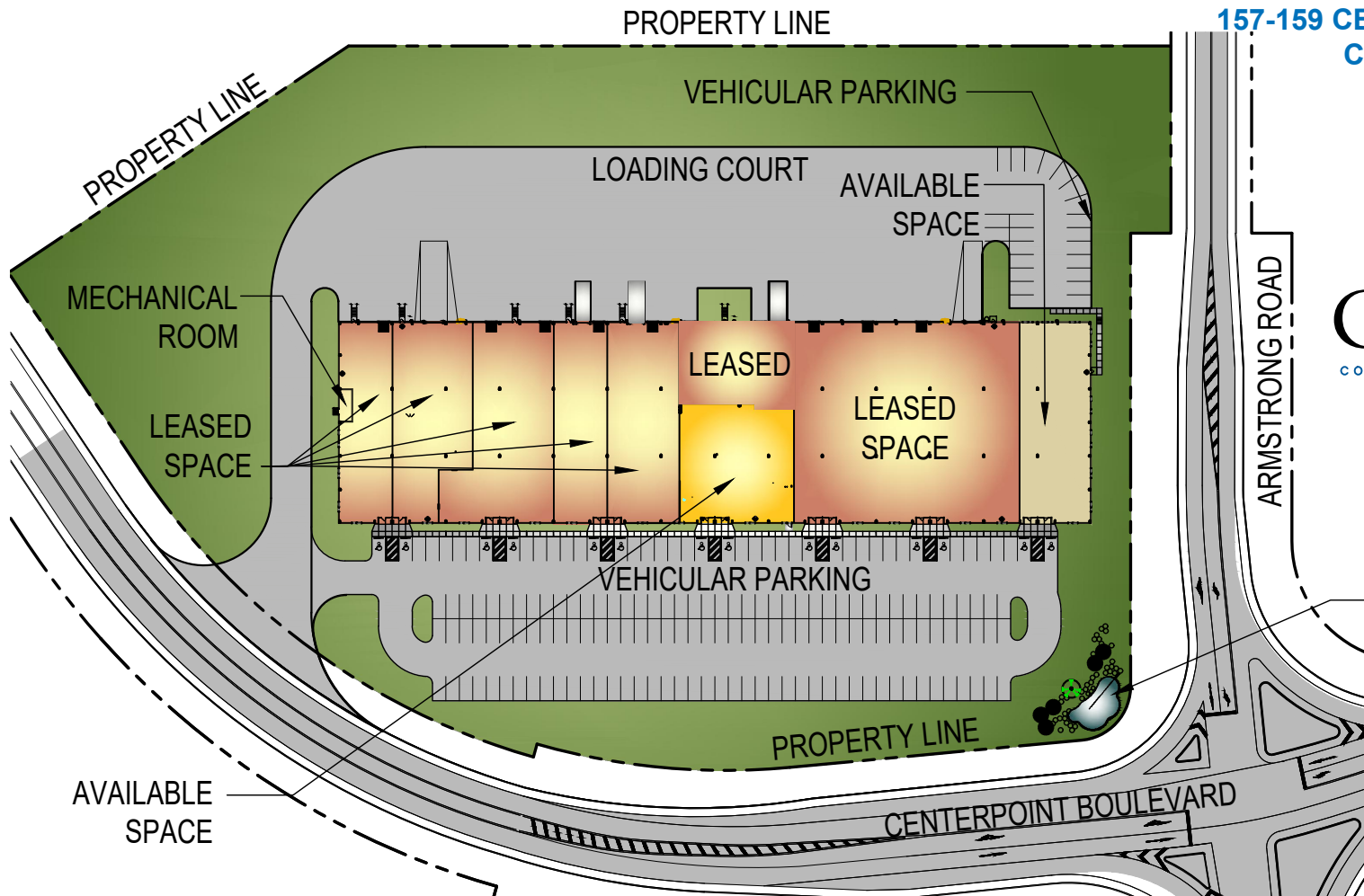

  
**CenterPoint**  
commerce & trade park • east

AVAILABLE S.F.	7,509 S.F.
PARKING SPACES	23
ACREAGE	8.55

WATER FEATURE

These plans have been prepared solely for  
marketing purposes for the exclusive use of  
-- Mericle Commercial Real Estate Services

F:\Job\2449\mdc\dwg-spec\mktg\157-159 CENTERPOINT BLVD 7509 SF office space (040220).dwg CK

570.823.1100  
mericle.com



East Mountain Corporate Center  
100 Baltimore Drive  
Wilkes-Barre, PA 18702

*Developing Northeastern Pennsylvania's I-81 Corridor Since 1985*

## EXISTING FLOOR PLAN

AVAILABLE 7,509 S.F. OFFICE SPACE WITHIN  
AN EXISTING 84,121 S.F. BUILDING

**PARCEL #2**  
**157-159 CENTERPOINT BOULEVARD**  
**CENTERPOINT COMMERCE**  
**AND TRADE PARK-EAST**  
**JENKINS TOWNSHIP**  
**PITTSTON, PA 18640**

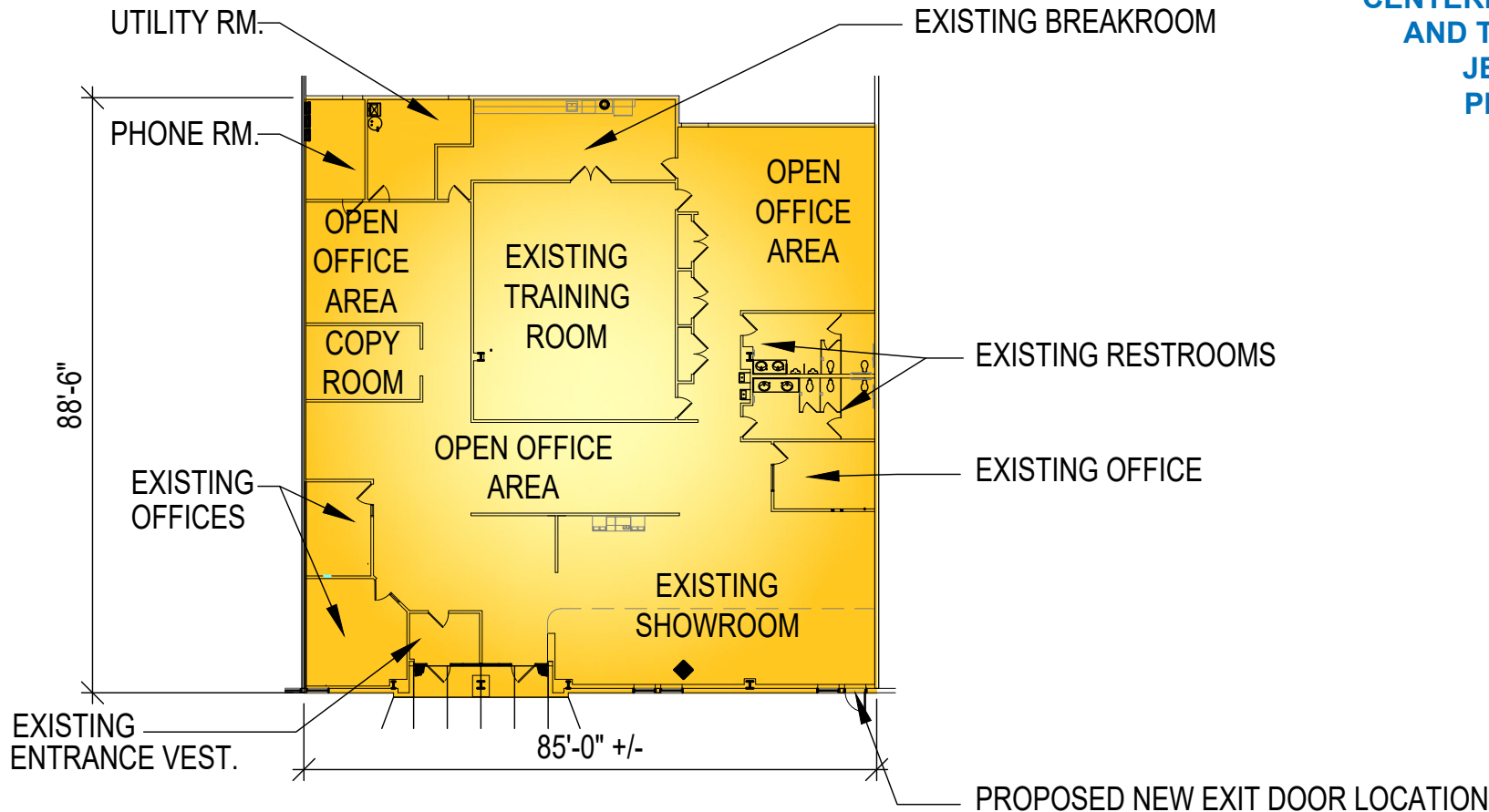

These plans have been prepared solely for  
marketing purposes for the exclusive use of  
-- Mericle Commercial Real Estate Services

F:\Job\2449\mdc\dwg-spec\mktg\MKMT- 157-159 CENTERPOINT BLVD 7509 SF office space (040220).dwg CK

**570.823.1100**  
**mericle.com**



East Mountain Corporate Center  
100 Baltimore Drive  
Wilkes-Barre, PA 18702

*Developing Northeastern Pennsylvania's I-81 Corridor Since 1985*

















Mericle, a Butler Builder®, is proud to be part of a network of building professionals dedicated to providing you the best construction for your needs.





